

**201624**  
**SH 18 A**  
**Sensor holder**

- For cylindrical sensors of  $\varnothing$  18 mm or thread M18
- Quick commissioning
- Reduced assembly / downtime due to one-piece construction
- Sensor replacement without changing the clamp position
- Limit stop for sensor replacement without readjustment
- Slots permit clamp adjustment

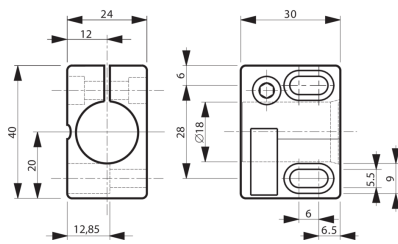

**Technical data (typ.)**

	<b>+20°C</b>
Hole spacing	28 mm
Mounting	Hole
Housing dimensions	24 x 30 x 40 mm
Clamping diameter	G: 18 mm
Housing material	Plastic (PA, 6 GK)
Component	Sensor holder
Characteristics	with limit stop
To be used for	Sensors with thread M18
Scope of delivery	Sensor holder

**More information / accessories**

<https://www.di-soric.com/201624>